

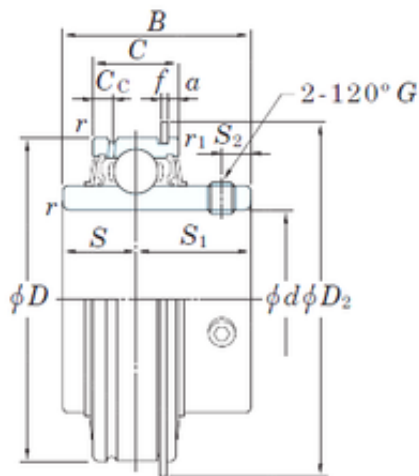

LY?MANUFACTURING CO.,LTD.



KOYO ER206-19 deep groove ball bearings

Bearing No. ER206-19

Size	30.1625x62x38.1 mm
Bore Diameter	30,1625 mm
Outer Diameter	62 mm
Width	38,1 mm
d	30,1625 mm
D	62 mm
B	38,1 mm
C	22 mm
S1	22,2 mm
a	3,18 mm
f	1,65 mm
r min.	1 mm
r1 min.	0,5 mm
C	5,5 mm
D2	67,5 mm
S	15,9 mm
S2	6 mm
Thread (G) - 1/4-28UNF	1/428UNF
Weight	0,39 Kg
Basic dynamic load rating (C)	19,5 kN
Basic static load rating (C0)	11,3 kN

ER206-19 Bearing 2D drawings and 3D CAD models